

# **Silent Gliss Motorised Curtain Track System SG 5600**

## **Limit setting via SG11422 test lead**

Supplied by



[www.sg-s.co.uk](http://www.sg-s.co.uk) email:[sales@sg-s.co.uk](mailto:sales@sg-s.co.uk) tel:0330 1272002

# SG5600 Limit setting via SG11422 Test Lead

## SG 5600 motor base overview

Automatic limit setting – Green Button A

Manual limit setting – White button M

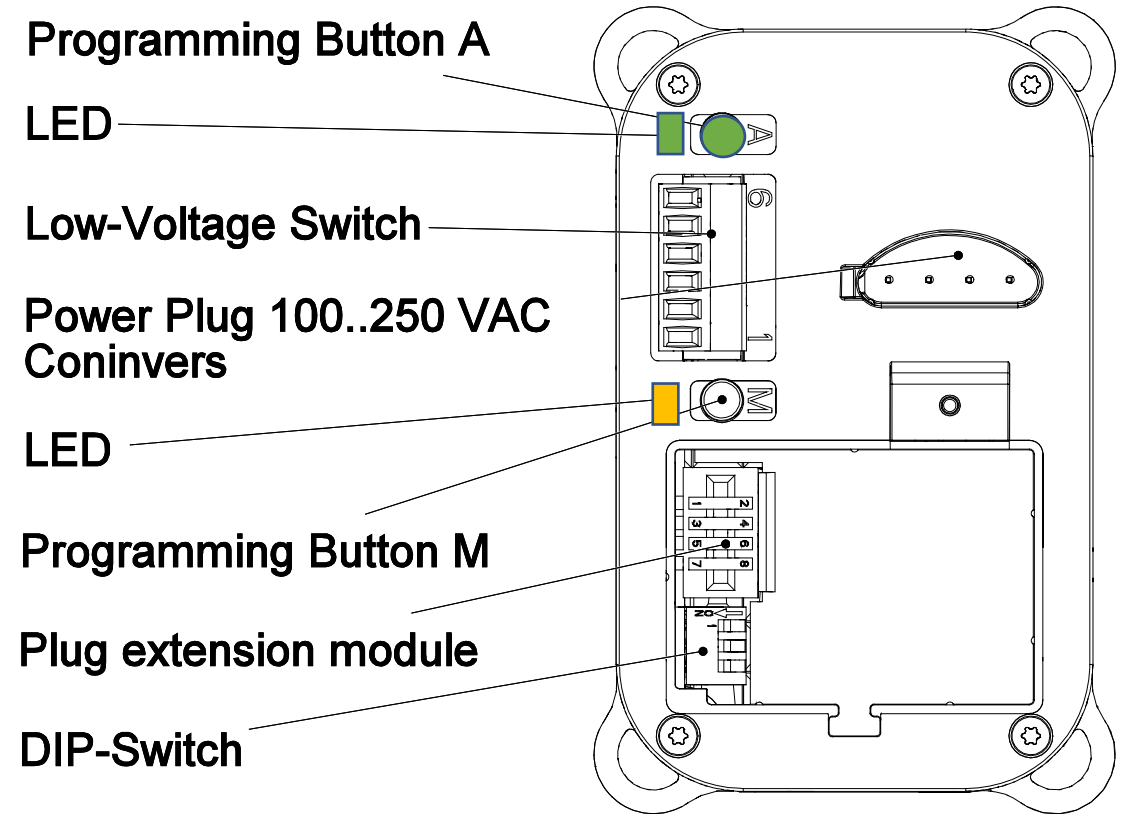

## SG5600 Limit setting with SG11422 test lead

**Method 1 - Automatic limit setting**

**Method 2 - Manual limit setting**

**Method 1 – Automatic limit setting using SG 11422 test lead.**

1. Ensure track is installed with motor and curtains hung
2. Connect in-line connectors from test lead to motor flex
3. Plug test lead into mains supply
4. Set lead into 'radio' mode by pressing set button for 1 second
5. Radio operation red LED is lit (permanent power is now supplied to the motor)

(Please note if the test lead is un-plugged it will revert to 2 way 240V switching mode)

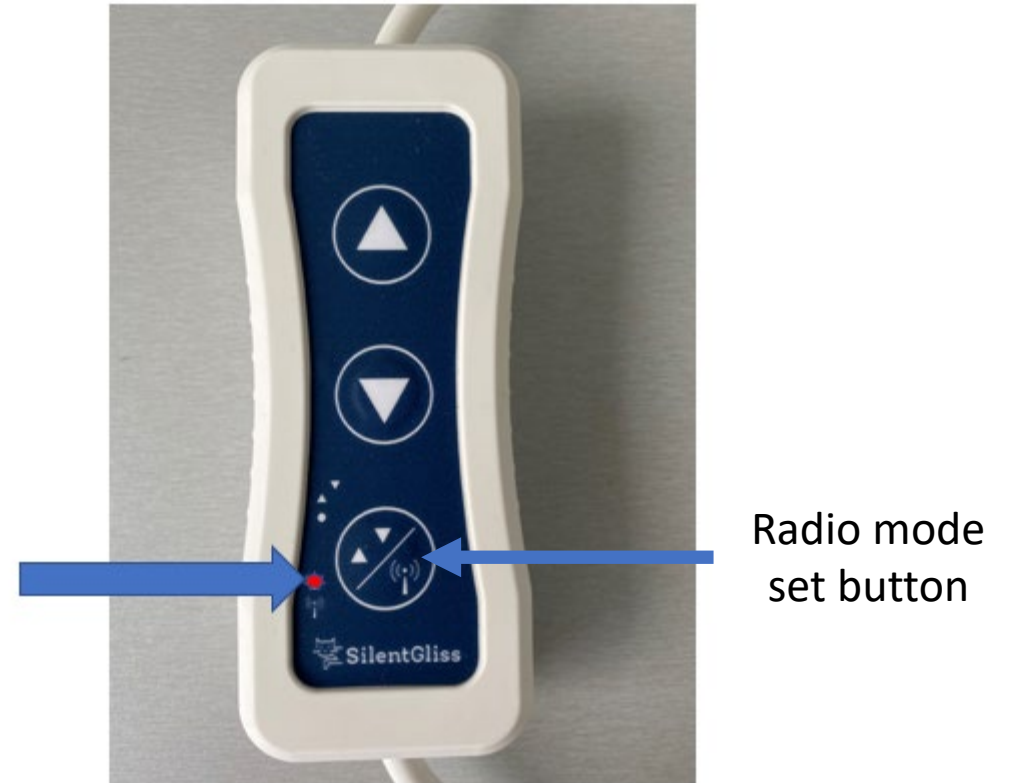

# SG5600 Limit setting via SG11422 test lead

## SG5600 Automatic limit setting

Automatic limit setting – Green Button A

5. Press the Green button A, push up and hold for 1 second – the green LED will now flash and the overlap arm / pilot will begin to move

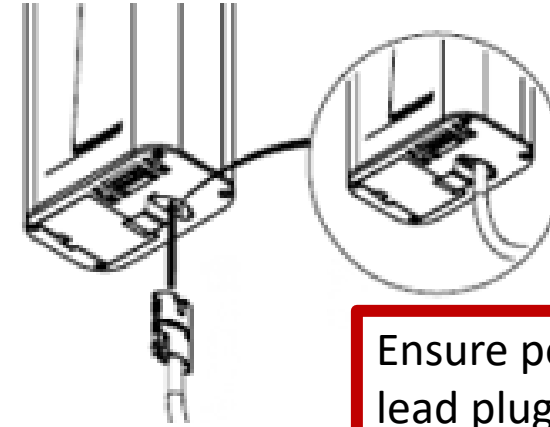

Ensure power lead plugged in

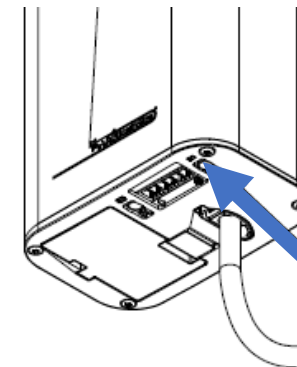

Press Green button A for 1 second,  
(Green LED will now flash)

# SG5600 Limit setting via SG11422 test lead

## SG5600 Automatic limit setting – motor overview

### Automatic limit setting – Green Button A

6. The pilot or overlap will travel to one end of the track, stop briefly , reverse a short distance then travel back to the same position.
7. The pilot or overlap will then travel in the opposite direction to the other end of the track , stop briefly , reverse a short distance then travel back to the same position.
8. The pilot or overlap will then travel a short distance in the reverse direction and stop.
9. The limit positions are now set.

Motor Travel Sequence During Automatic Limit Setting

Wait until all travel has stopped !

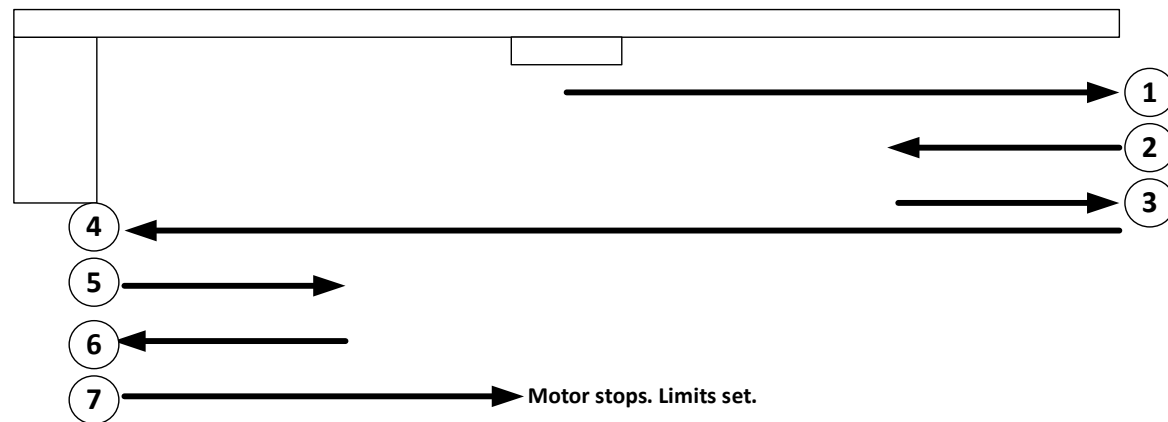

# SG5600 Limit setting via SG11422 test lead

## Method 2 – Manual limit setting using SG 11422 test lead.

1. Ensure track is installed with motor and curtains hung
2. Connect in-line connectors from test lead to motor flex
3. Plug test lead into mains supply
4. With the power turned on the lead will automatically be in manual limits setting mode (upper LED on as indicated)



# SG5600 Limit setting via SG11422 test lead

## SG5600 Manual limit setting

5. Press the White button M, push up and hold for 1 second –  
(the Yellow LED will flash once a direction button on the test lead is pressed)

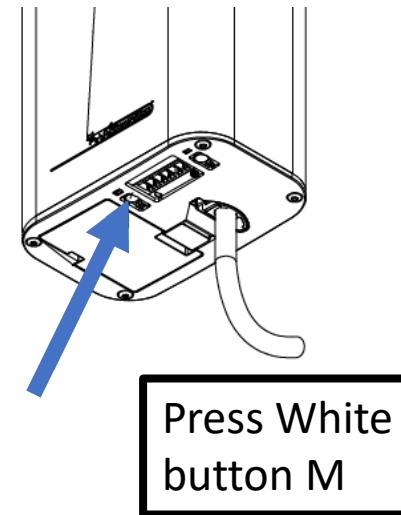
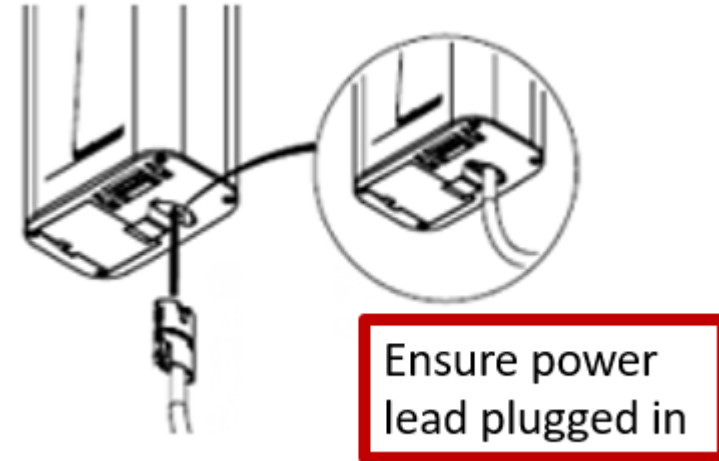

# SG5600 Limit setting via SG11422 test lead

## SG5600 Manual limit setting

6. Push and hold button in first direction until the desired position is reached – then release.  
Pulse button for precise positioning  
(Minimum movement in the first direction must exceed 500 mm).

7. Push and hold button for the opposite direction until the second end position is reached - then release.





## SG5600 Limit setting via SG11422 test lead

### SG5600 Manual limit setting

8. Push and hold button in first direction until system stops.  
Limits are now set and stored

Limits can also be set using the same procedure with:

Standard radio wall switch / hand held transmitter

Dry contacts

