

## 0336 Instruction Manual

### Overview

The handheld case for use with the 0336 silent gliss wireless remote. For instructions on addressing/ setting up the keypad see 01914A manual enclosed.

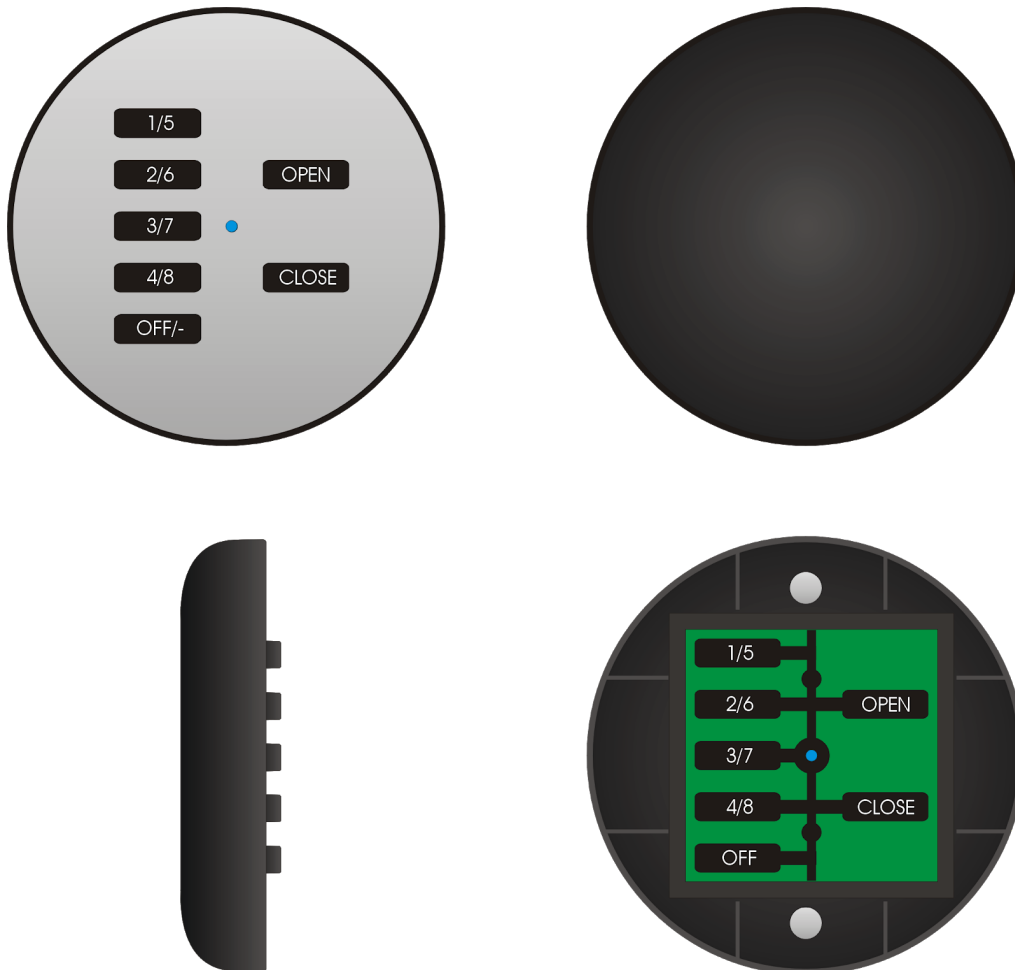

### Installation

The 0336 will come pre-assembled but sometimes, for example to set the dip switches or change the batteries, the internal keypad may have to be removed.

When inserting the keypad into the 0336 case it is important that it is oriented correctly. The diagonal arrow should always be pointed towards the top of the keypad. The magnets should be vertically aligned.

Small slots are provided in the webs around the inner perimeter of the case to locate the aerial.

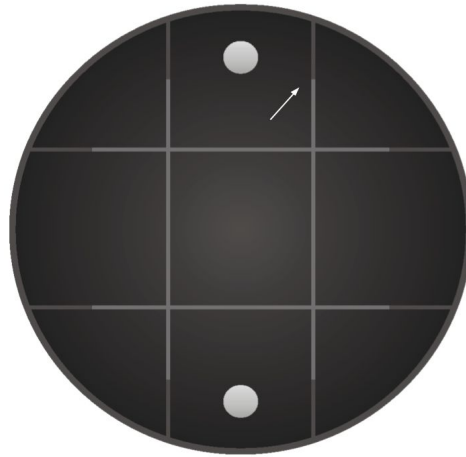

## NB

*Care must be taken to keep the aerial in the grooves. If the aerial is not seated correctly or trapped under the 0336 keypad the front plate will not be able to be secured correctly.*

## Removal

The base of the 0336 case has three small feet, one of which has a small hole in the centre. To remove the front plate push a small pin or straightened paper clip through the hole to break the grip of the retaining magnets.

